

THIS DRAWING IS THE PROPERTY OF SUMITOMO HEAVY INDUSTRIES, LTD. (SHI) AND IS CONFIDENTIAL. IT SHALL NOT BE REPRODUCED, NOR USED FOR ANY OTHER PURPOSE, NOR SUBMITTED TO OUTSIDE PARTIES WITHOUT SHI'S PERMISSION.

| NO. PIECE FOR 1 SET | DESCRIPTION | MARK | MATERIAL | MASS kg | | STANDARD NO. | MATERIAL SPEC. |
|---------------------|-------------|------|----------|---------|-------|--------------|----------------|
| | | | | FOR ONE | TOTAL | | |
| | | | | | 24 | | |

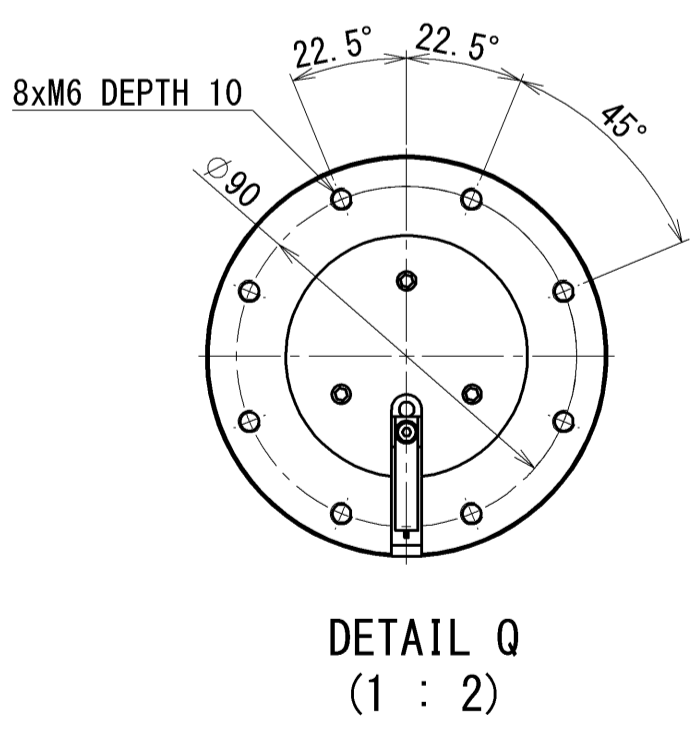
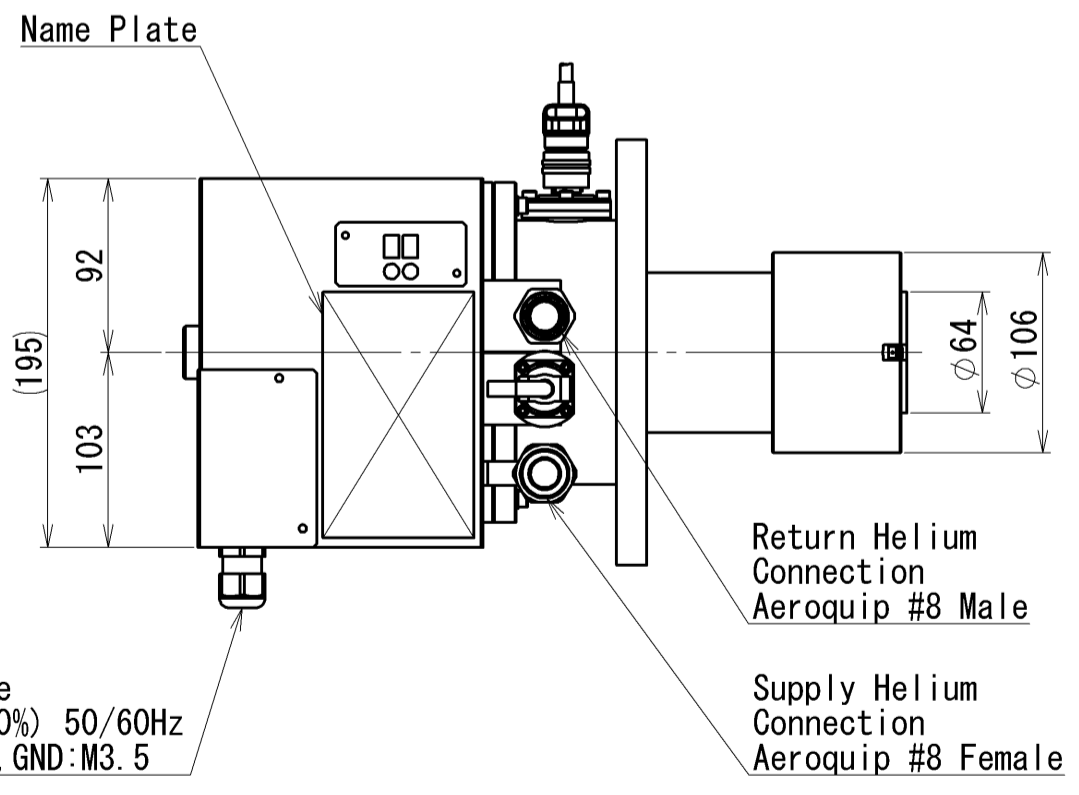
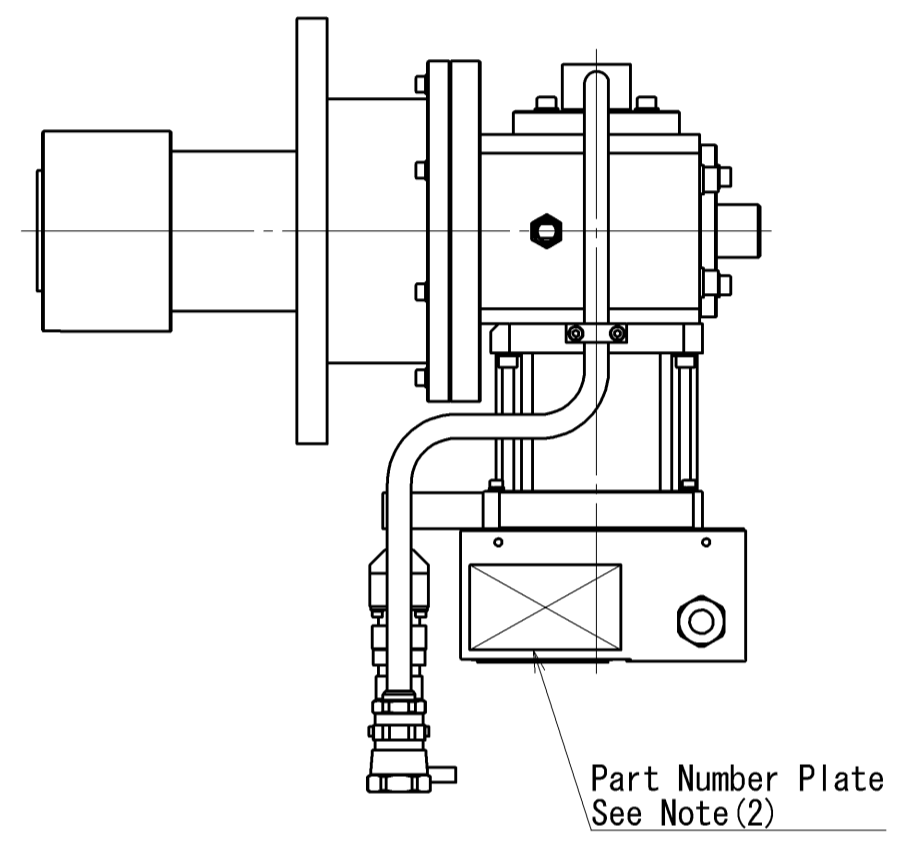
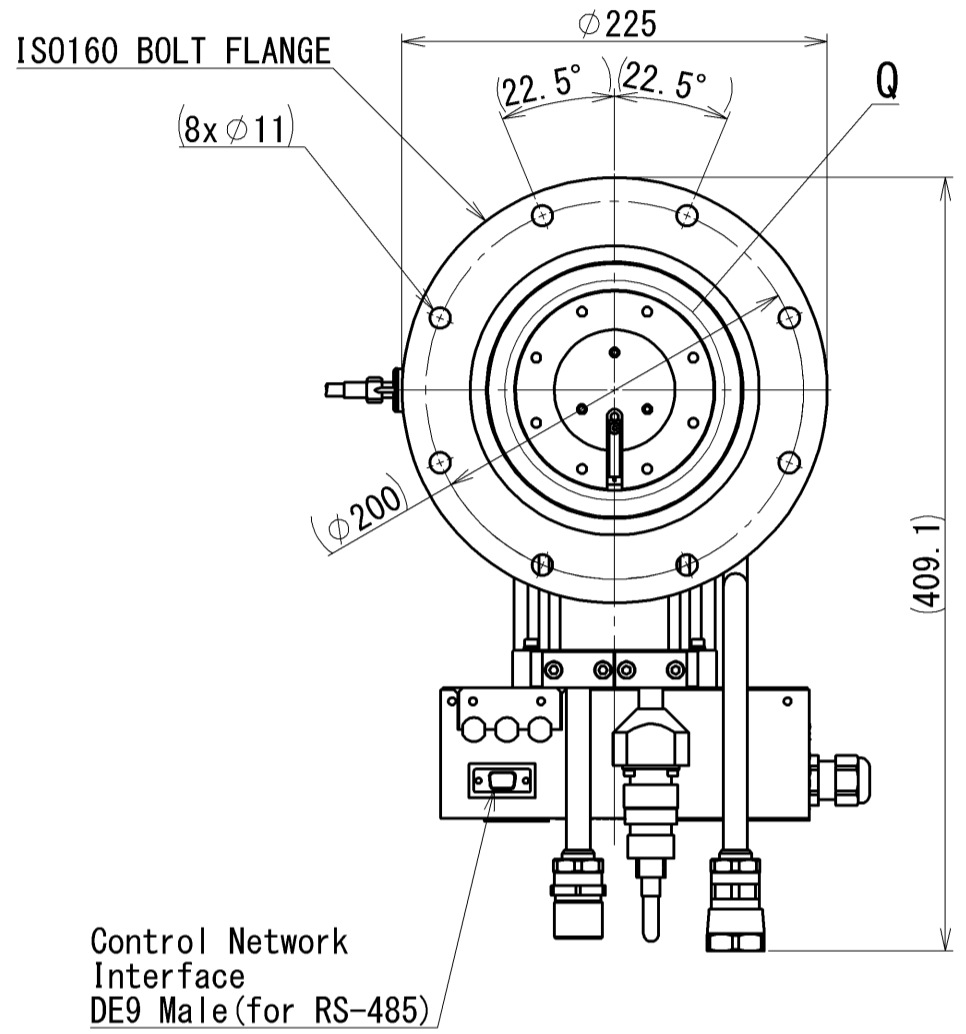
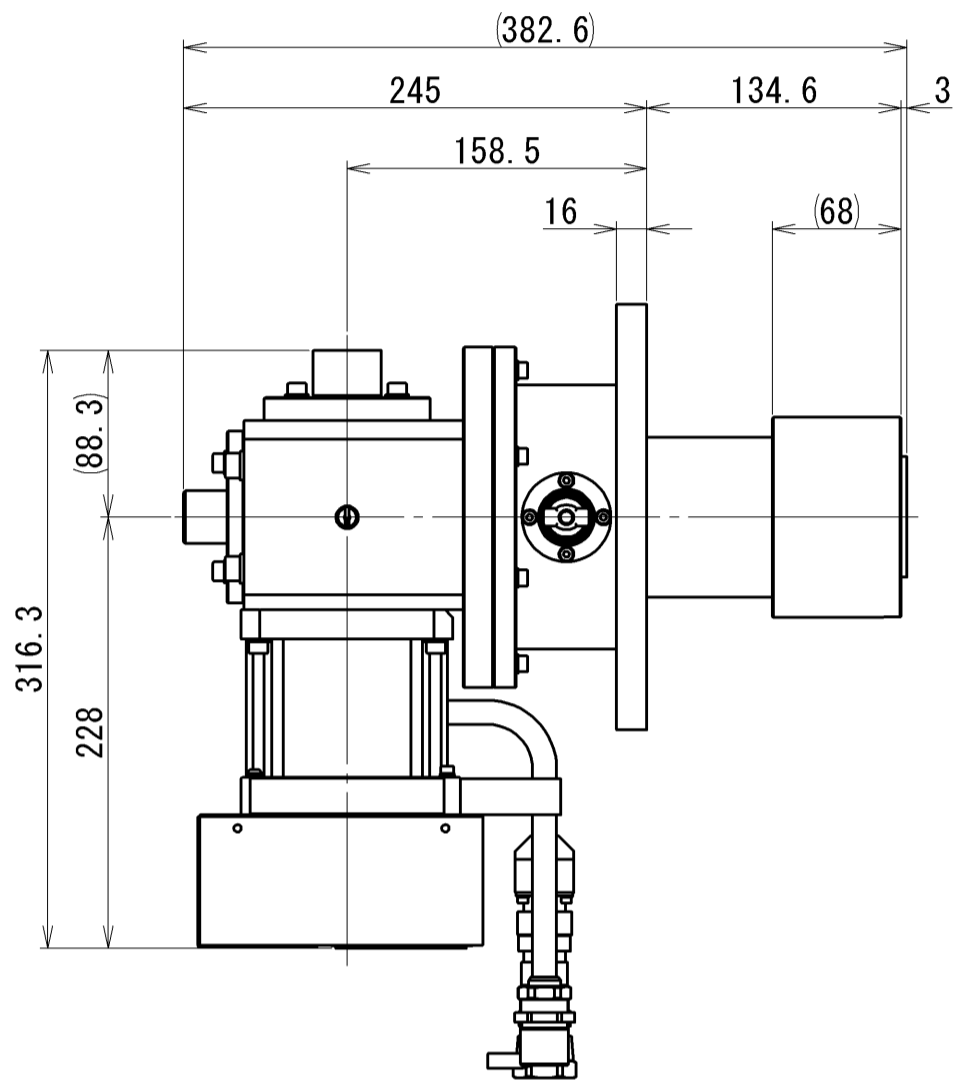

NOTE
 1. CHARGED HELIUM GAS 1.65-1.70MPa.
 2) PART NUMBER PLATE DETAIL.

COLD TRAP
KZ-06BPP0T0A3
Sumitomo Heavy Industries, Ltd.

MADE IN JAPAN
SHI PART NO.
KZ-06BPP0T0A3-0

METRIC

| | | | | | |
|--------------|-------------|------------|------------|---------------------------------|--------------|
| SCALE | 1:4 | DATE | 2022/04/07 | Cold trap KZ-06BPP0T0A3 | |
| DRAWN | T. Sakamoto | DESIGN | J. Tamada | INSP. | T. Yatsu |
| | | | | APPR. | M. Nakamura |
| NEW DRAWING. | | | | DESIGN CHANGE No. | |
| NUM REV | DESCRIPTION | DATE | BY | Sumitomo Heavy Industries, Ltd. | |
| | | 2022/04/07 | J. Tamada | SHI P/N : KZ-06BPP0T0A3-0 | |
| | | | | DWG. NO. | RG21ZH2395AQ |